



CHURCHILL DIVERSION ARCHAEOLOGICAL PROJECT

Level Summary Record

Site No. Loustrom Unit No. 6 Level 2 (10-20 cm)

Depth from Surface \_\_\_\_\_ Depth from Datum \_\_\_\_\_

Excavator(s) B.A. Nicholson Date May 22/85

Excavation Method shovel & trowel

Screened yes (1/4") Size 1/4"

Photos B & W # 12 & 13 Colour # 14 & 15

Deposits (color & consistency) Dark Black silt

Disturbance (plot & describe) \_\_\_\_\_

Remains Recovered: (Scatter gram on back with legend)

- Lithic Tools \_\_\_\_\_
- Lithic Debris flake & core fragment
- Ceramics body sherd
- Bone trochlea from large ungulate
- Shell \_\_\_\_\_
- Other five cracked rock

Features (ref. & plot.) \_\_\_\_\_

Remarks: \_\_\_\_\_

N  
↑

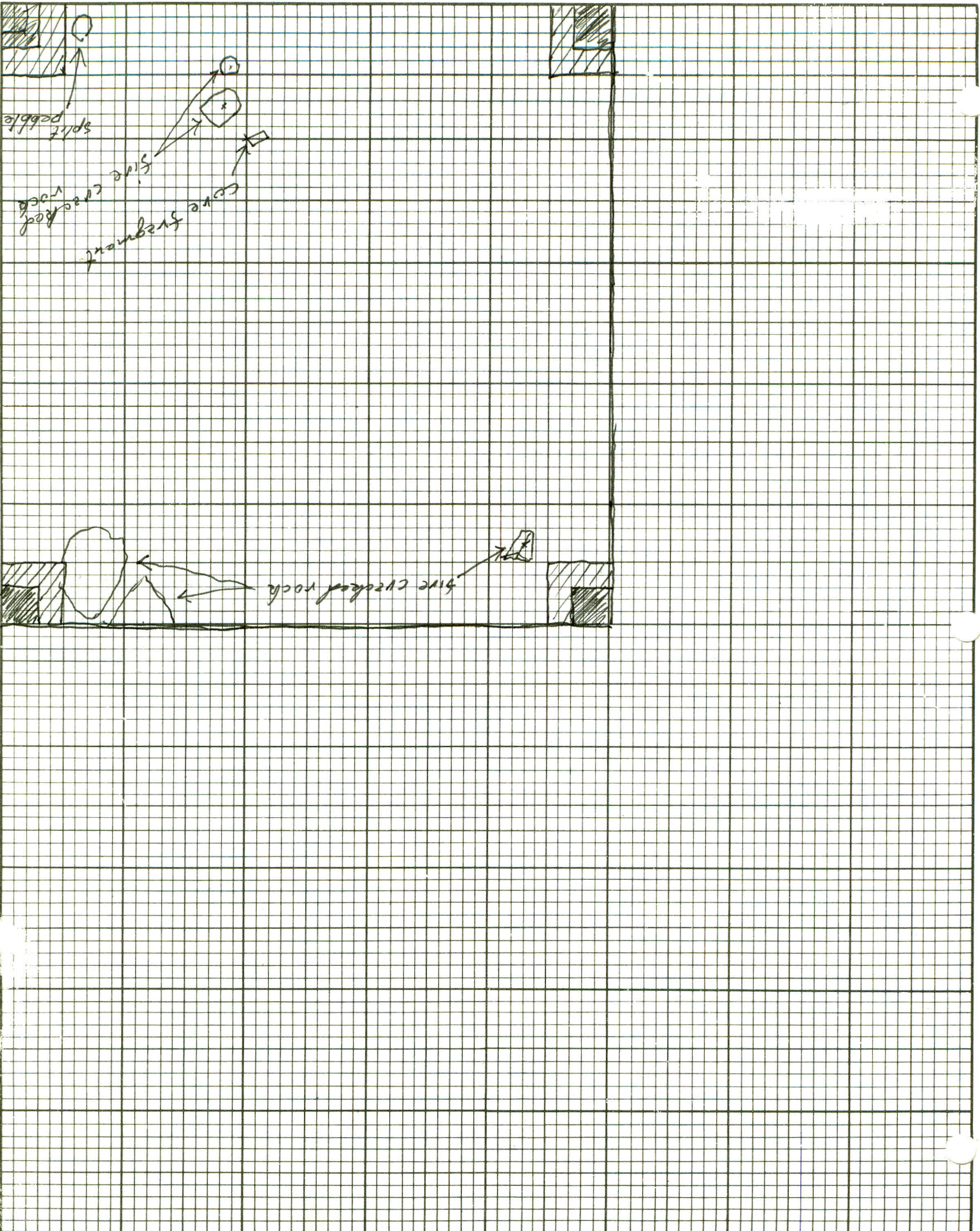



CHURCHILL DIVERSION ARCHAEOLOGICAL PROJECT

Level Summary Record

Site No. Loustron Unit No. # 6 Level 3

Depth from Surface 20-30 cm Depth from Datum \_\_\_\_\_

Excavator(s) B.A. Nicholson & Marc Perling Date May 22/85

Excavation Method shovel & trowel

Screened Yes Size 1/4"

Photos No

Deposits (color & consistency) \_\_\_\_\_  
\_\_\_\_\_  
\_\_\_\_\_

Disturbance (plot & describe) roots  
\_\_\_\_\_

Remains Recovered: (Scatter gram on back with legend)

- Lithic Tools \_\_\_\_\_
- Lithic Debris flakes
- Ceramics \_\_\_\_\_
- Bone tiny fragments
- Shell \_\_\_\_\_
- Other bits of fine cracked rock

Features (ref. & plot.) \_\_\_\_\_  
\_\_\_\_\_

Remarks: entering light A/B transition soil  
- took soil sample from possible hearth area  
below S.C. rock in SW corner  
\_\_\_\_\_  
\_\_\_\_\_  
\_\_\_\_\_

N ↑

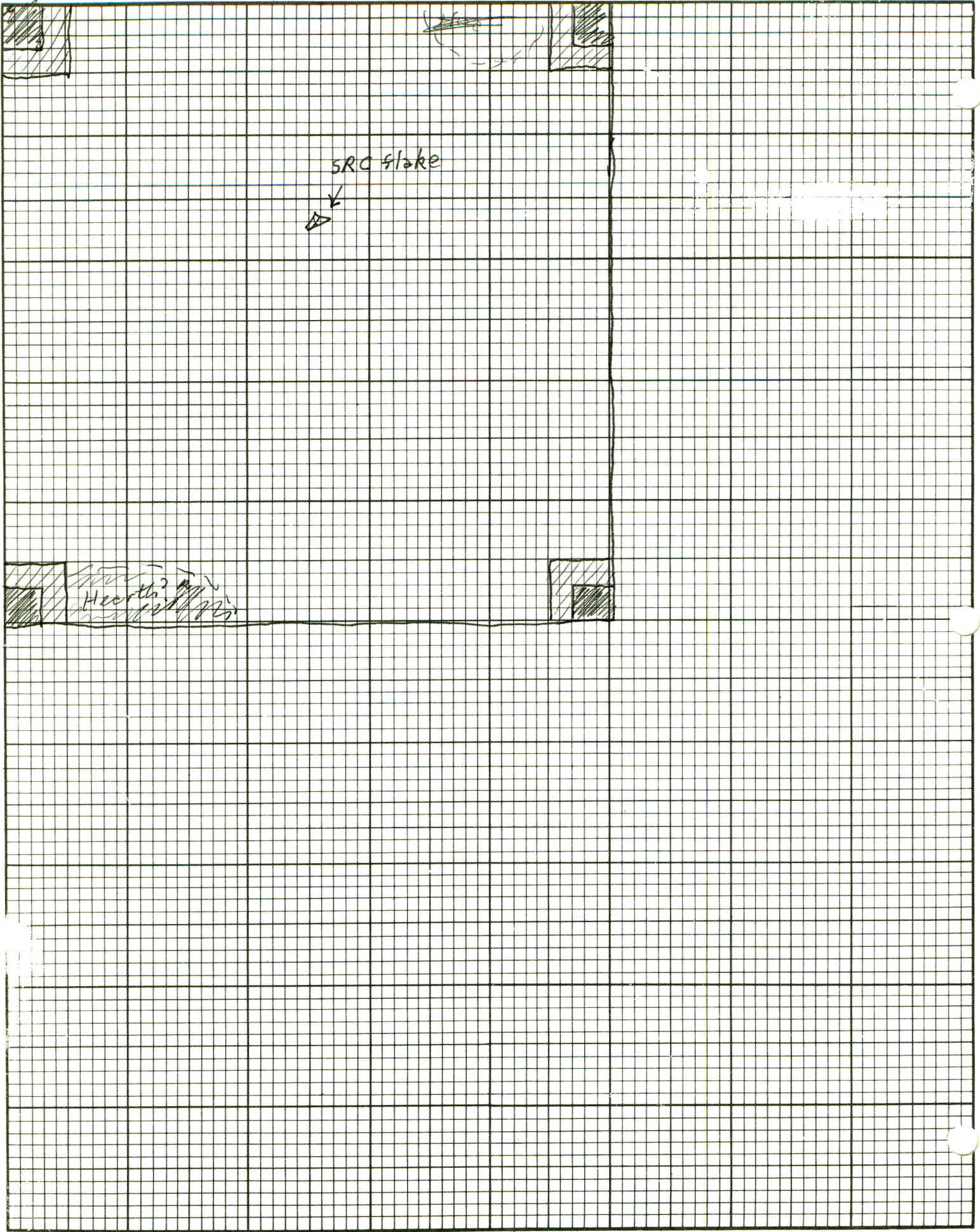

SRC stake



Heorth?