

FIELD NOTE BOOK

SITE

Loustrum SITE

NAME

Scott Hamilton, Brenda Kramarchuk

DATES

May 17 / 85

TO

PAGES

TO

FUNCTION

Field Notes

Historic
Resources
Branch



IndexEX 1 — 2, 5, ~~6~~, 7, 10Changes in unit designations
& datum corners pp 20, 19

EX 2 — 2,

3 — ~~2~~, 5, 6

4 — 3, 5, 8, 10

5 — 3, 5, 7, 9

6 — 3, 5, 11

7 — 6, 9

8 — 12, 15, 16

9 — 12, 16

Sketch map = 14

Speculations & Ramblings 5, 13

Camera Designation 1

tick count 18

Loostrom site

Friday May 17/85: In afternoon B. Nicholson & S Hamilton met in Brandon and made plans for dig. Went to B.V. loaded some stuff and went out to Loostrom site. We unloaded the stuff into the cabin loaned by the Loostroms. It is a very nice setup: frig, tables, lights, dishes etc.

We went to site and extended the base line from 200NOE up to 250NOE and then east and west to create turning points to set up units in "meadow" and under to oak tree next to field.

Got back to Brandon by 6:00 pm. Left a grocery list with Bev and made arrangements for everyone to get to site the evening of Sun May 19/85.

Note: Camera Roll designation

85-B-1-1
↑ ↑ ↑ ↑
year box roll exposure
No No

85-C-1-1
↑ ↑ ↑ ↑
year colour roll exposure
No

Monday May 20/85

= Got to field ca 8:00 AM.

started shooting in units.

Dan & Mark setting up EX 1 at 250N72W

- Removed level 1: Fairly thick sod layer = some pore frags appearing in soil below sod...
- Remove level 2 = exposure of a few larger limb bone frags. Dan took a C¹⁴ sample of the largest ones in case we don't get anything better → (he has red marking pen on it). He will be wrapping all the larger pieces in case we have to get a composite sample

Sylvia & Steve at EX 2 at 280N16E

- Removed level 1 (0-10 cm). a few bone bits & lithics / ceramics, textile, hair, body sheds. It's hard to tell were plow zone ends (clay filled rodent hole in first 10 cm).
- Removed level 2 (10-20 cm). artifact frag dropping off.
- Removed level 3 (20-30 cm) artifact frag virtually gone.
- level 4 ripped off and unit cleaned up to ± 50 cm bs. A very shallow deposition all in plow zone...

Brenda & Kate ^{& Jenny} at EX 3 at ~~21~~ 201N60E

- Removed level 1 (0-10 cm) : They are getting moderate quantities of bone...
- Removed level 2 (10-20 cm) = Brenda thinks conc of bone is going up, but only in S half - The north half is starting to lighten up as if the tan B horizon is coming up (only 20 cm down).
- Removed level 3 (20-30 cm) = next to nothing (little faunal)
- Removed level 4 (30-40 cm) 1 flake & bone frag → possibly from rodent disturbance in south end.
- cut down north edge a bit to exposed B horizon. ready to profile unit.
- a coarse sand & gravel lens below B horizon see profile...

Bew at EX 4 200NOE

Bew took off part of level 1: fair cone of bone (some buried) lithics & a bit of pottery right in root mass.
 Sylvia started level 2: she is getting larger pieces of bone appearing - they are pedistated to be worked down → should be taken as a carbon sample. She also got a few body shields → one textile impressed and one plain. A pit of "gravel" found in level → (see Ex 5)

Mark at Ex 5 151NOE

Level 1: removed sod & roots: some cultural material a couple of core frogs, bone frogs etc.
 level 2: at about 12 cm bs mark started encountering more and more gravel... not much cultural stuff showing up... probably will dis or be sterile by level 3. A bit surprising given the thicker deposition in Ex 4 on the other side of the gully. Ex 5 is located at a higher altitude so it may not have as much soil developed on top.

Bew & Steve Ex 6 62N30E

level 1: not much in level: hit top of FCR in bottom of level:

level 2: more FCR in south margin as well as frog of ungulate humerus - textile impressed body shield.
 Bew is speculating that he might have the edge of a hearth in south margin of unit.
 He left the unit half completed with the message that there is some bone in north half that is half pedistated. The distribution of FCR & bone to be plotted on level summary in the event he does have the edge of a feature.

Unit 2 on the "top of the knoll" near the oak tree had very shallow deposition ... By level 3 most of the recoveries had dropped off → a yellow brown silty clay loam encountered at ± 30 cm bs ... Very slow soil development → all cultural deposits on "high" knolls disturbed by cultivation.

Mr. Hoover commented that he plowed no deeper than 10 inch ... With that as the maximum there may only be 2 to 5 cm of A horizon undisturbed up near Unit 2.

Unit 3 in the vicinity of the gully is somewhat better. Brenda is working down level 2. She thinks she is getting a little more bone as she goes down. I⁹ could be there is a little more soil deposition (slope wash) over top of the occupation zones in this area ... If that's the case we may have an undisturbed component → (no luck)

Unit 4 Bev is taking off the sod & scrub and is already coming up with cultural material → bone, burned bone things & pottery. He is about 5-8 meters north of the gully. This unit may be promising given its proximity to the gully and as it is partially sheltered by rising ground to the N. & W. ← not that much of a rise though.

Unit 5: Mark is located on opposite side of gully from Unit 4 and is getting much sparser recovery. He is on higher ground on a north facing "slope". May be an explanation for difference from Unit 4.

Unit 1: Dan isn't far enough along yet to tell for sure what is happening. I think it may well have better deposition than usual. (ie XU 2 and 3)

Unit 6: Bev got this unit started in afternoon. It is lower down behind a "upland" to the north. I⁹ also seems wetter. He is getting a relatively good recovery, but again it's too soon to tell.

The exposed deposits, particularly on the knolls are pretty well a write off → the plow zone is probably reaching down almost to the B horizon → we will try one more spot in field. I⁹ looks like very shallow deposition → later and maybe small single component localities ...

May 21/85 Tue.

Unit Summary

XU 7 : 223N 30E : Brenda & Kate:

- = set up a new unit in field in an area with a dense surface distribution of bone. This unit is hoped to yield a larger core of "undisturbed" bone in hope of a carbon sample.
- = They removed level 1 & 2 with only moderate success.
- = a point tip (KRF) ... we didn't get our bone samples only small bits & pieces
- = By end of level 2 the tan brown subsoil starting to appear. : Artifact
- = By end of level 3: dark soil gone and artifact yield dropped right off: a few rocks starting to appear
- = They are going to shovel out the north half of unit for profile ... Brenda is hitting lots of rock ... No second A horizon.

XU 3 = Unit complete, shoveled down to 40 cm bs. virtually sterile level 4. shoveled out north half down to ± 75 cm bs. Photographed north profile (85-B-1-4,5) and profiled it (85-C-1-4,5) unsprayed wall hard to define boundaries (sprayer marks). There appears to be a bit of ~~sub~~ soil filling with a dark humic layer being buried below silty clay and developing A horizon. The artifacts however are limited to the top organic layer. I don't think any of the top layer escaped the plow. There is a hard clayey intrusion at contact between first A & B horizon \rightarrow may be rodent disturbance. Below the 2 B horizon is a distinct coarse sand & gravel layer - no excavation below it.

The double A horizon with the intervening "erosion" layer is not surprising as the unit is situated in a shallow "gully" with a rise to the south and some knolls to the north. May be at the head of a gully that appears distinctly to the west.

Brenda wrapped a carbon sample consisting of a carpal bone. nothing else available.

Unit Summary

EX 1 250N72W = Dan traveling down level 2 = lots of small "irregular" bone frags / one of which is wrapped for dating (too small).
 He has got 1 K.R.F. flake ← the first distinctly cultural thing.
 The soil remains gray/black top soil.
 - Afternoon = Dan still at level 2 = I think he is taking it off a little deep but it may be the slope & he is finding a few bones fragments, the largest of which he is wrapping &
 - Virtually no distinct lithics and no pottery?? Oda.

EX 5 151NOE = Marc removing level 2 he is getting large conc of rock & coarse "sand & gravel" immediately below the ~~the~~ sod. The recoveries are sparse a few bone bits, 2 pieces burned bone and a couple of possible flakes. pretty clearly it must be located on top of a gravel knoll with very little soil development on top.

Marc completed level 2 not much cultural stuff among the rocks. He shoveled out the north half in preparation of a profile.

Not much can be said about this unit → virtually no cultural material or even a soil & obviously not an attractive spot to camp. (or dig!)

Unit Summary

Ex 4. 200NOE: level 2: Scott & Mars remove level.

Best unit for datable bone so far.

- Will take 3 carbon samples.

- 1 distal end of humerus

- 2 prox end metacarpal

- 3 prox end Ulna / radius

= large bone is at about same depth (see level summary) as two point frags - 1 complete side notch = no description.

1 triangular base = late

- 1 possible uniface frag.

= A fair bit of small bone frags and ^{some} flakes - also a body shield (textile impressed).

= I was concerned that I was going to rip right through the occupation layer with a 10 cm level so I split it into 2a & 2b = each 5 cm thick. The same level summary is used, but the two sublevels are bagged separately.

= I don't think this unit will go down much further as more pebbles & cobbles starting to appear.

= Will take a floor spot of unit prior to pulling carbon samples.

May 22/85

In field ca 8:30.
- Ben arrived 10 ish

Ex 7 223N30E: Profile & Photographs done ^{85-B-1-89}
^{85-C-1-89}
Not much to be said about this unit. It has
a thinner A horizon than Ex 3 and no second
argonic layer below. Probably no undisturbed
material. No large bone recovered for est sample.
Only exciting thing is point tip.
I am surprised that there is so little A horizon
given that the unit is located in a low area n.w.
of the gravel knoll.

I think that units in the field aren't going to give us
anything "datable" = too shallow a deposition → no
undisturbed material. Perhaps the only use for
further testing would be to shovel spade a large
block to collect ceramics ... surface collection
might be just as useful...

- I think that the majority of the large bone in the field
has been brought to the surface by the hortonom's
garden tiller.

Ex 5 151N0E = Profile & Photographs done ^{85-b-1-10,11}
^{85-c-1-10,11}
= This unit reveals little other than the
thin deposition on top of the till (On these
knolls the till is being near the surface without
the tan B horizon. The A horizon soil is
developed virtually on top of the gravel till.

The sparse deposit of artifacts is limited to the
A horizon etc. This sparsity is certainly suggestive
of how unattractive the spot is for occupation.
(ps not even a good source for lithic material.)

Unit Summary

Unit Summary

Ex 1 250N 72W : Kate & Brenda finished level 2 and started level 3... While level 3 is still in the block A horizon, the bone frag is dropping off dramatically. Probably the B horizon is not far below. They got a few bone frags, a cathead shell core frag & a few flakes so far.

= level 3 = The B horizon starting to show in places - As few artifacts are being found they will show level 4

= shovel showed level 4 = well into B horizon so just shoveled out north half for a profile.

= Not likely got enough material for a date = few lithics and I don't think any pottery recovered.

= Plan Profiled & Photos taken = 85-C-1-21
85-C-2-1, 2
85-b-1-18, 19

Ex 4 200N 0E = Marc removing level 3. At about 22-23 cmbs he hit the contact between a A & b soil horizons. The artifact frag had dropped off dramatically a few stones starting to appear.

- We are through the occupation level & into the sterile spl-s soil. Probably hit the gravel in next level. - just like Ex 7.

- This area will likely be the primary loci of future work → see (on next year's excavations).

- It looks like a single component - a block excavation may well yield the dated activity area. Bew is after!

- Completed the profile & photographed 85-b-1-14, 15
85-c-1-17, 18

*: Only unit with good C¹⁴ sample and diagnostic artifacts.

Unit Summary

Unit Summary

Unit Summary

Ex 6 b2N30E = Ben & Marc removed levels
 2 & 3 = Photos after 2:00 ← FCR frags.

Level 3 had only 2 flakes & perhaps a bone
 Frog

Level 4 & 5 should showed they were sterile &
 and then took a 20 cm trench out of south
 wall = hit B horizon at 60 in SW corner
 & 70 in SE corner. The bottom 40-50
 cm of unit was sterile.

= thin scatter of material = body sherd,
 FCR etc at ca 15 cm. ← Got a frag
 of humerus at ca 15 ← (14 samples)

= The south profile reveals a very faint inclusion
 of a gray-brown soil of similar texture to the
 surrounding A horizon =

= Also of interest the contact between A & B horizons
 slopes downward to east about 10 cm across the
 1 meter unit.

= The thick deposition of A horizon would indicate
 an accumulation of soil from slopes to the north
 & west. The soil is also moister than any of the
 others - The presence of red willow in the
 creek valley wall west of this unit would indicate
 groundwater or spring running through this area.

Profiled a Photos taken = 85-c-1-19, 20
 85-b-1-16, 17

Unit Summary

May 23/85

Started work ca 8.30.

= Scott probed & photographed EX 11 and EX 10
 shot in EX 9 90N 25W.

EX 8 250N 1W : Brenda & Kate

- Level 1 removal = cutting through root mat and into
 A horizon. A few flakes and bone frags. Also
 2 textile impressed body sherds - extremely thin walled
 vessel. The same stuff that Bev was after in the
 field, but in undisturbed forest.
 They got a little deep in level 1 \Rightarrow 1" medium
 sized bone is appearing in NE corner will be exposed
 in level 2 \rightarrow possible C14 sample.

EX 9
 - Level 2 = exposed 12 frags of FCR & several bone
 frags the tops all ca 1.5 cm bs. They got
 of pins in level \rightarrow Blackish profile but with
 "matched" impressions in top and exterior oblique that
 don't look like c.w.o.'s. They will collect all the bone
 possible for C14. They are also getting lots of lithics.

EX 9 90N 25W : Don & Marc

- Level 1 removed = fair amount of small bones: better than usual
 lithic recovery - mostly KRF. They also got 2-3 ceramic
 bits: normal wall thickness textile impressed; 1 may have
 a void stamp on it...

Speculations =

= After a walk about yesterday I have a feeling what is happening about the site. The creek valley is extremely deep with steep walls. Several deep gullies flow into this valley; 2 of the most prominent are along the east side. They provide the easiest access down to the valley → even these gullies are quite steep walled, and provide an easy grade up to the prairie level.

= I have a feeling that the primary artifact yielding zones are located at the north end of the site in the vicinity of these gullies.

= Perhaps the steep ^{creek} valley and gullies provided an entrapment area. That is, bison could be driven either up the creek valley and diverted into the lower ends of the gullies, or simply trapped in the steep walled valley. I don't think bison would have much success climbing up these crumbly, slumping slopes.

= Alternately, the gullies provide the easiest means of descending to and/or from the top prairie level into the creek valley and thereby into the Souris River Valley.

= In any case, the habitation / processing areas on top would get water from the creek and the gullies would provide the most suitable transportation corridors.

⇒ If the bison trap in the creek valley & gully area idea pans out, there should be a "pound" and kill and primary butchering zones in the creek bottom & walls. I might be tough to find it as the unstable banks of the valley might have slumped down on them. Mr. Harstrom commented that he had recovered a bison horn core from the creek valley. I think I will spend some time walking up & down the main gullies to see what they look like...

⇒ Upon tramping about a bit more, the gullies look to be very old. The actual creek flood plain is about 20-30 feet lower than the outlet of the gullies. They probably would not be good places to divert bison up. Going down might be more effective... i.e. run them down the gullies over the slope into the creek valley and get them milling in a "pound". In any case, the identification of

* = mole hills with bone, buried bone & textile impressed body & herbs

field

Farm

NE 24 T6 R19 sec 22

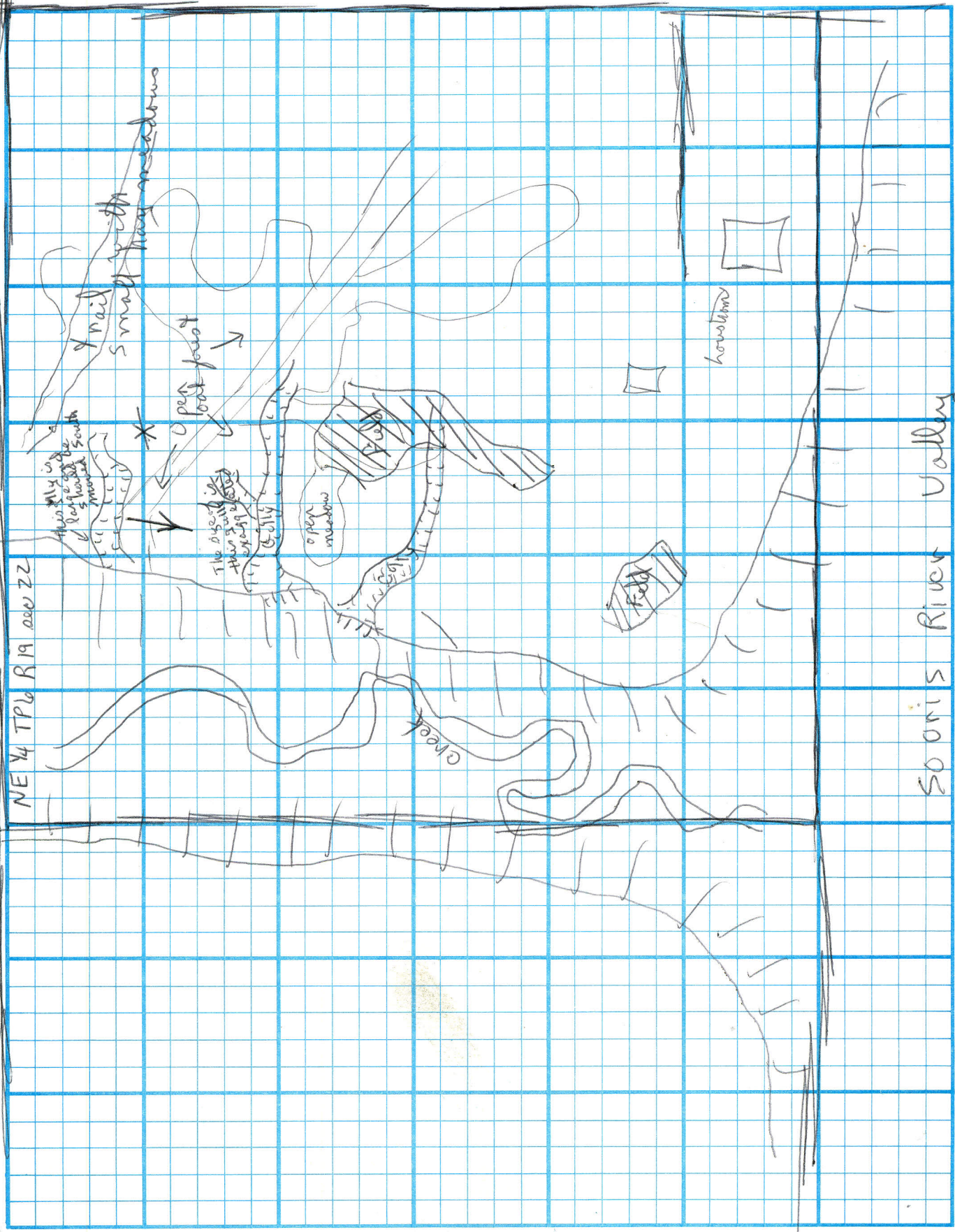

bone (burned & unburned) and a couple of textile impressed body sherds well to the north (in mole hills) certainly indicates a number of camp loci at the heads of these gullies... (see map on page 14).

Ex 8 250N 1W Brenda & Kate
 = completed level 2

Ex 8 250N 1W

- completed level 2 = not very much in level: they thought they might be through cultural layer. Therefore started to shovel above level 3.
- level 3 = started shoveling → dumped into some large cranial frags... some knocked out with shovel or were wrapped as C14 sample ^{cranial} material in NW wall left in situ in pedestal and they are resuming to shovel...

May 24/85 Friday.

16

Working by 8:30 AM.

Scott backfilled all units except Ex 8 & 9. I started hauling equip - took another walk. I think the localities to the north in.

near the 2 northerly gullies may prove very fruitful - nice open oak forest locations whose boundaries marked by gullies. Mole hills in this area reveal relatively dense quantities of burned & unburned broken bone and even 3 sherds of textile impressed pottery & body sherd.

Ex 8 : 250N1W.

Brenda & Kate travelling of level 3 : They have part of tooth row (probably maxillary) pedistalled → There are also FCR as possible SRC carb. and limestone cobbles appearing. The soil colour is lightening up. They are probably getting close to the B horizon → the till deposits are within the B horizon here...

The last of level 3 reveals a completely tan brown B horizon with no artifacts... They will shovel out the north half down to ±55 cm for profiling.

= Unit profiled & photoed 85-C-2-8,9

85-b-1-30,31

= Frog of tooth row pulled from wall at ±22 cm bs for C¹⁴... We may have enough bone wrapped for a date.

Ex 9 : 90N 25W.

Don & Marc showed level 3 : The tan soil appearing everywhere except in rodent holes. The artifacts seem to be limited to the A horizon (stayed ca 24 cm bs). They will shave level 4 just to be ~~sure~~ sure no goodies in rodent holes.

- Level 4 was shoveled and shaved down with few goodies - the rodent holes are no longer visible and it is tan brown B horizon all over. They will

shovel it out to 50-60 cm bs for profiling.

profiled & photographed.

85-C-2-6,7

85-b-1-28,29

= This unit yielded larger quantities of F.C.R. & lithics than usual (levels 1 & 2) even got a rim sherd... Not much else to report...

Unit summary

Unit summary

They wrapped a little bone for C¹⁴ → anal enough

Completed excavation by noon → finished profiling & backfilling (2 beer bottles in each hole).

= Got everyone's tents down, dishes washed, truck loaded, time sheets filled out, notes & artifacts sorted, Max deticked and ready to sit down and share the last beer for coffee break...

= I have left all the stakes in place (including unit ones) in case Bev needs them later for reference markers. The ones in the field will have to be pulled right away so Mr Loustrom can work his field.

= I can't remember which flying pens are the Loustrom's and which are B. Y's ... I will leave them all there for Bev to sort.